

LANDSCAPE CALCULATIONS	
GROSS SITE AREA	75,171 SF
BUILDING AREA	16,443 SF
NET SITE AREA	58,728 SF
58,728 X 10% =	5,873 SF
SITE LANDSCAPE AREA PROVIDED:	7,731 SF
BUFFERYARD - NORTH PL	
SIX FOOT MASONRY WALL (EXISTING) = 15 POINTS	
10 FOOT AVERAGE BUFFERYARD WIDTH = 5 POINTS	
3 ORNAMENTAL TREES/50' = 5 POINTS	
TOTAL POINTS = 25	

THESE NUMBERS ARE BASED ON AN ADDITIONAL 4' SIDEWALK ALONG REAR OF BUILDING AND SHIFTING THE FIRELANE 4' TO THE NORTH

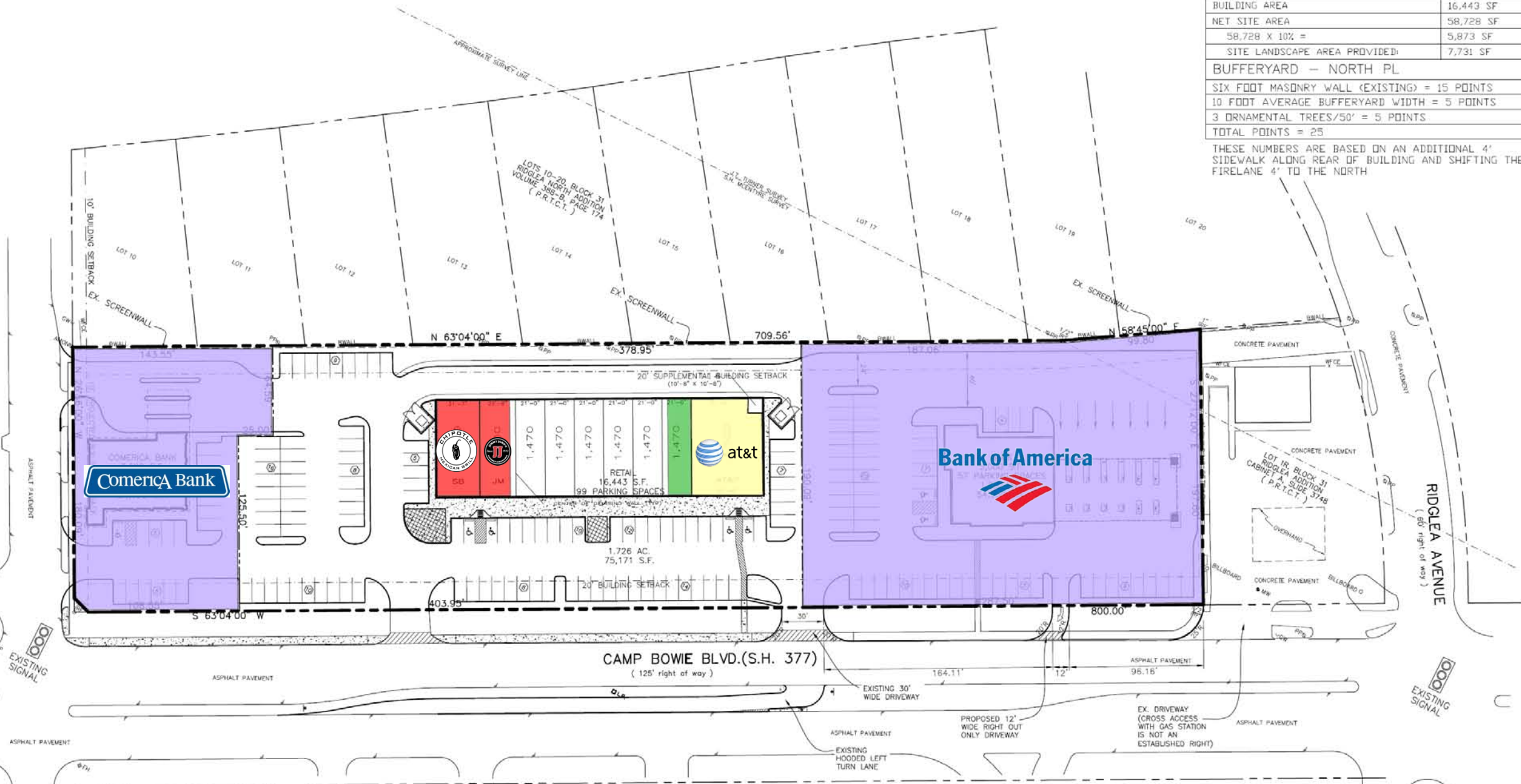

- LOI NEGOTIATIONS
- LEASE IN PROCESS
- EXECUTED LEASE
- EXECUTED GROUND LEASE

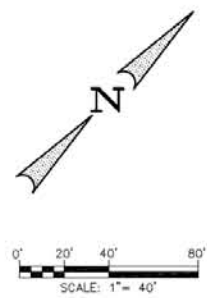
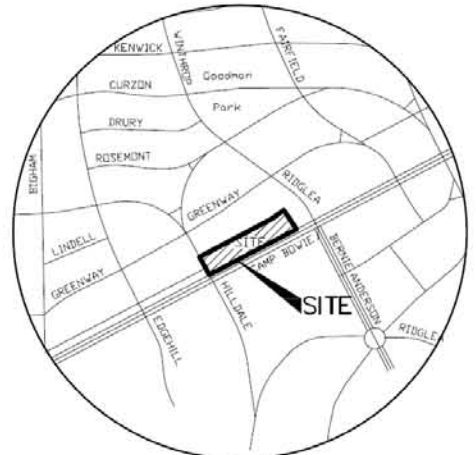

LEGEND	
PP	Power Pole
CW	Guy Wire
MH	Manhole
WV	Water Valve
TP	Telephone Pedestal
WM	Water Meter
PH	Fire Hydrant
LP	Light Pole
IV	Irrigation Valve
CO	Clean Out
AC	Air Conditioner
TV	Cable Box
SB	Signal Box
SP	Signal Pole
SN	Sign
IRF	Iron Rod Found
IRS	Iron Rod Set
SS	Sanitary Sewer
SW	Storm Sewer
GV	Gas Valve
BOL	Ballot
MBOX	Mailbox
HCSN	Handicapped Sign
BWALL	Brick Wall
TMH	Telephone Manhole
EMH	Electric Manhole
GRAIL	Guardrail
WFCE	Wood Fence
CFCE	Chainlink Fence

POSTED SPEED LIMIT: 35 MPH

BENCHMARK
 47154 in the West end of a 5' inlet in front of House #6462 Camp Bowie Blvd. Inlet is on the N. curb lane of Camp Bowie approximately 240' West of the W curb line of Edgell Rd.
 Elev. 724.353 feet.
 ± 63' Southeast of approximate centerline of Camp Bowie Blvd., X-cut found on top of curb median nose of approximate centerline of Ridgela Ave.
 Elev. 738.90 feet.